

# High Performance SMA Connector

## PSF-S02-000, 001

www.gigalane.com



GigaLane High Performance SMA Connectors are designed for applications up to 26.5 GHz in the common high frequency substrates and it is suitable for military and microwave frequencies.

### ► Specification

#### Electrical

Frequency	DC ~ 26.5 GHz
Impedance	50 Ω
VSWR	1.2 : 1 (@ 18 GHz) 1.3 : 1 (@ 26.5 GHz)
Insulation Resistance	5000 MΩ
Dielectric Withstand Voltage	1000 Vrms Max
Contact Resistance - Outer Conductor - Inner Conductor	2mm Ω max 3mm Ω max
Insertion Loss	0.4 dB max(@26.5 GHz)
RF Leakage	-90 dB
Power Handling	200W (@2 GHz)

#### Environmental

Temperature	- 40℃ to + 125℃
Thermal Shock	MIL-STD-202, Method 107, Condition B
Corrosion (salt Spray)	MIL-STD-202, Method 101, Condition B, 5% salt
Shock	MIL-STD-202, Method 213, Condition I
Vibration	MIL-STD-202, Method 204, Condition D (20G)
Moisture Resistance	MIL-STD-202, Method 106

#### Materials

Body	Stainless Steel (Passivated) Brass (Gold Plated)
Center Contract	Beryllium Copper / Brass (Gold Plated)
Insulator	PTFE

### ► Drawing

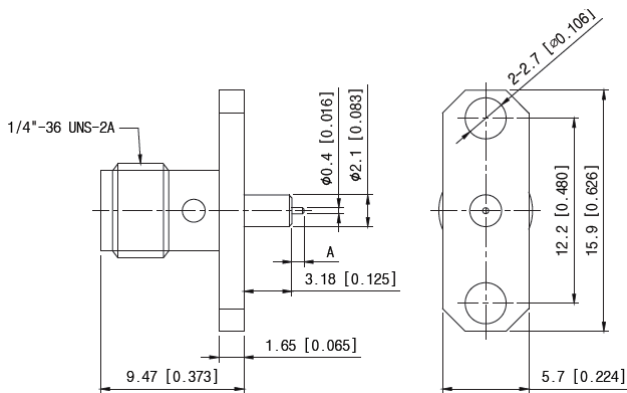

Unit : mm [inch]

Part No.	DIM A
PSF-S02-000	0.80 [0.03]
PSF-S02-001	1.50 [0.06]