

# SMA Connector

## PAF-S00-003

www.gigalane.com



GigaLane SMA(Sub Miniature A) connectors are widely used in the frequency range DC to 18 GHz with low loss characteristics. SMA connectors are most used in military, microwave frequencies and telecommunication application.

### ► Specification

#### Electrical

|  |  |
|--|--|
| Frequency  | DC ~ 18 GHz                            |
| Impedance  | 50 Ω                                   |
| VSWR   | 1.2 : 1 (@ 6 GHz)<br>1.3 : 1 (@ 18GHz) |
| Insulation Resistance  | 5000 MΩ                                |
| Dielectric Withstand Voltage                                 | 1000 Vrms Max                          |
| Contact Resistance<br>- Outer Conductor<br>- Inner Conductor | 2mm Ω max<br>3mm Ω max                 |
| RF Leakage   | -90 dB                                 |
| Power Handling   | 70W (@2 GHz)                           |

#### Environmental

|                        |   |
|------------------------|---|
| Temperature            | - 40℃ to + 125℃                               |
| Thermal Shock          | MIL-STD-202, Method 107, Condition B          |
| Corrosion (salt Spray) | MIL-STD-202, Method 101, Condition B, 5% salt |
| Shock                  | MIL-STD-202, Method 213, Condition I          |
| Vibration              | MIL-STD-202, Method 204, Condition D          |
| Moisture Resistance    | MIL-STD-202, Method 106                       |

#### Materials

|                 |                     |
|-----------------|---------------------|
| Body            | Brass (Gold Plated) |
| Center Contract | Brass (Gold Plated) |
| Insulator       | PTFE                |

### ► Drawing

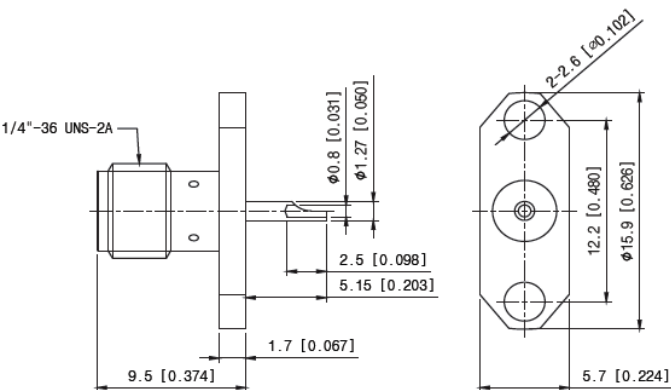

Unit : mm [inch]

|          |             |
|----------|-------------|
| Part No. | PAF-S00-003 |
| Type     | Panel Mount |
| Gender   | Female      |