

# MCX Connector

## PDF-R00-000

www.gigalane.com



GigaLane MCX Connectors are intended for use with microwave application requiring excellent performance up to 6G Hz in 50 Ohm impedance. MCX connectors are similar in design to SMB connectors but smaller than SMB connectors. Typical applications for MCX connectors include GPS, wireless communication and automobiles.

### ► Specification

#### Electrical

|                              |                  |
|------------------------------|------------------|
| Frequency                    | DC ~ 6 GHz       |
| Impedance                    | 50 Ω             |
| VSWR                         | 1.2 : 1 to 6 GHz |
| Insulation Resistance        | 5000 MΩ          |
| Dielectric Withstand Voltage | 750 Vrms Max     |
| Contact Resistance           |                  |
| - Outer Conductor            | 2mm Ω max        |
| - Inner Conductor            | 6mm Ω max        |
| RF Leakage                   | > 60 dB          |
| Power Handling               | 50W (@2 GHz)     |

#### Environmental

|                        |                  |
|------------------------|------------------|
| Temperature            | - 40℃ to + 125℃  |
| Thermal Shock          | CECC22220 4.6.7  |
| Corrosion (salt Spray) | CECC22220 4.6.10 |
| Vibration              | CECC22220 4.6.3  |
| Moisture Resistance    | CECC22220 4.6.4  |

#### Materials

|                 |  |
|-----------------|--|
| Body            | Brass / Beryllium Copper (Gold Plated) |
| Center Contract | Brass / Beryllium Copper (Gold Plated) |
| Insulator       | PTFE                                   |

### ► Drawing

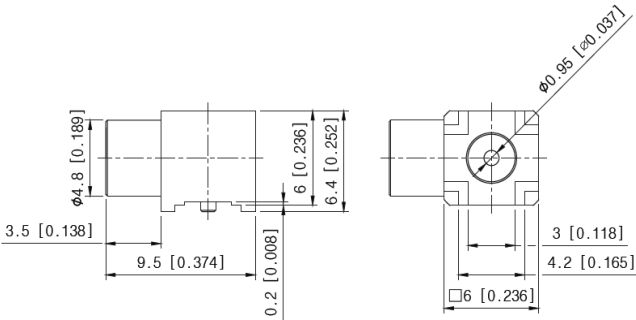

Unit : mm [inch]

|          |             |
|----------|-------------|
| Part No. | PDF-R01-000 |
| Type     | PCB Mount   |
| Gender   | Female      |